



ANNUAL SELF INSPECTION AND  
SERVICE INSTRUCTIONS



# INFLATABLES PFD'S

## ANNUAL SELF INSPECTION AND SERVICE INSTRUCTIONS

It is recommended that an accredited service agent conducts a full inspection of your PFD every five years.

**Read/Print this owner's self-inspection manual in conjunction with Owner's Manual**

1. Read the following instructions carefully. If you require any assistance regarding self-servicing of your inflatable PFD you are advised to contact one of our accredited service centres for advice. The self-service instructions are for Marlin manufactured PFD's for recreational use only not for commercial. If PFD is used commercially, servicing should only be by an authorised accredited service centre every 12 months.
2. The green firing indicator located on the side of the CO2 inflation mechanism will be broken, ensure you have purchased green firing indicators before starting, as well as CO2 cylinders and automatic cartridge/bobbins. Bobbin should not be older than 5 years - all these parts are available through Marlin retailers or authorised certified service centres.
3. Always use the Marlin self-inspection certificate to maintain a record of the inspection/service.

**WARNING: If a component fails any of the inspection steps or indeed the PFD fails to operate - the PFD must be replaced or the faulty component replaced before further use. In this circumstance the PFD must be sent to Marlin authorised accredited service centre for further tests to be conducted.**

**WARNING: You must not repair any part of the PFD during inspection/service.**

### Inspection 1:

- 1.1 General Visual Inspection
  - a. No wear or damage to the outer cover of the PFD
  - b. Outer cover closure is not working (zipper if applicable or hook/loop)
  - c. No damage to webbing straps
  - d. Buckle operation is correct (open and close buckle)
  - e. Load indicator thread is not broken if applicable
- 1.2 Open outer cover and check
  - a. Oral inflation tube has no damage.
  - b. Whistle (Blow to check operation)
  - c. Grab strap no visual damage
  - d. Retro reflective tape is firmly attached and not damaged.
- 1.3 Models fitted with integral safety harness check that all harness components have no visible damage or excessive wear.
  - a. Check webbing
  - b. Stainless steel buckles
  - c. Stainless steel D-Ring
  - d. Stitching
  - e. Load indicator for broken stitch
  - f. Grab strap
  - g. Whistle attachment
  - h. Crotch strap/Holding down strap

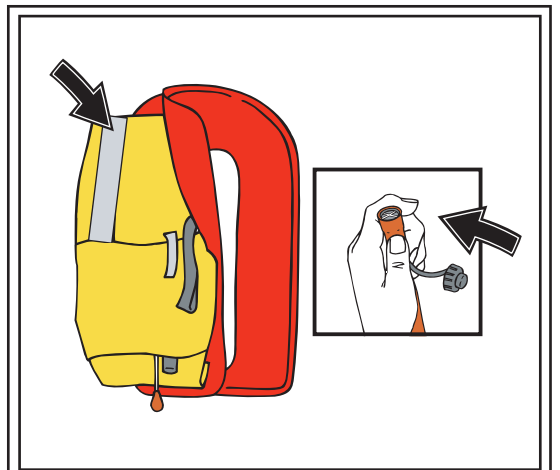
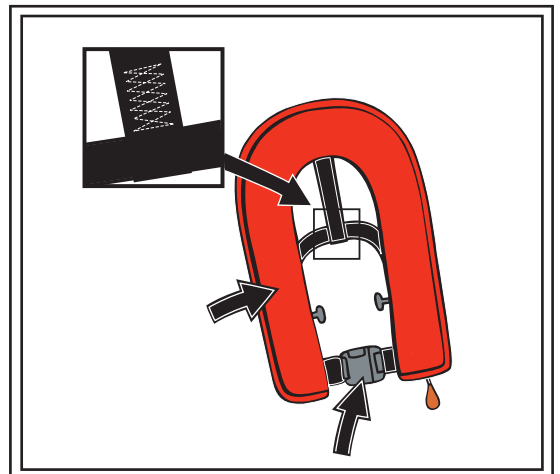

## Inspection 2:

### 1.1 Inspection of the Bladder

- Open cover and inspect bladder has no signs of excessive abrasion or wear. Pay extra attention to folds and area around inflation systems.
- Inflate bladder by using red oral tube. leave the inflated PFD 12hrs in a room with stable temperature of around 20C. If the temperature goes down overnight, this will affect pressure. Check there is no loss of pressure and no visible damage to the bladder.

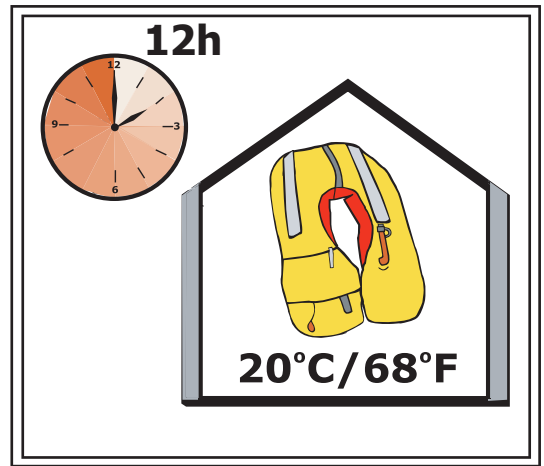
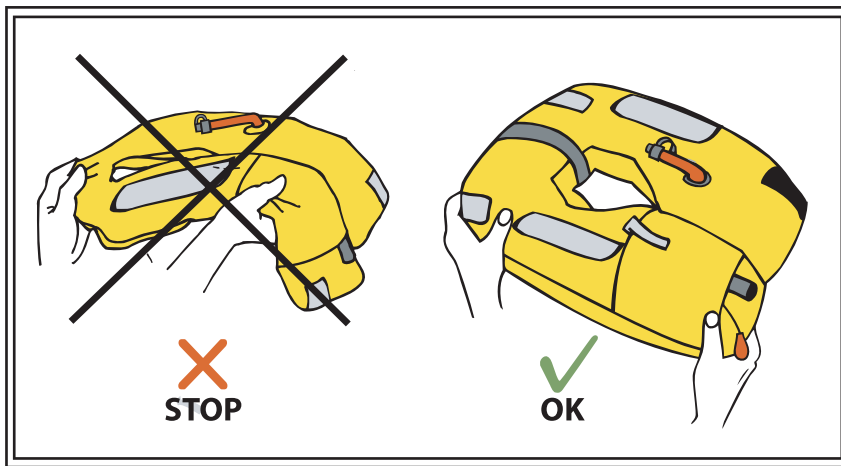
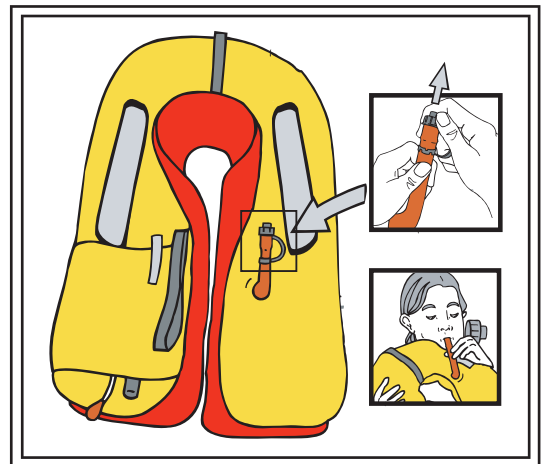

**If the bladder is damaged or the pressure falls, the PFD must be replaced or sent to an accredited service station for further tests. Under no circumstances must you attempt to repair the PFD.**

Inspection of mouth inflation tube and its valve. Check mouth inflation tube and valve operate correctly. Deflate the life jacket by inverting the cap and placing the tab onto the top of the mouth inflation tube. Press cap gently to expel air. When PFD is fully deflated replace cap to normal position. Do not put anything other than the inverted cap down the oral inflation tube to deflate as foreign objects may damage the valve.

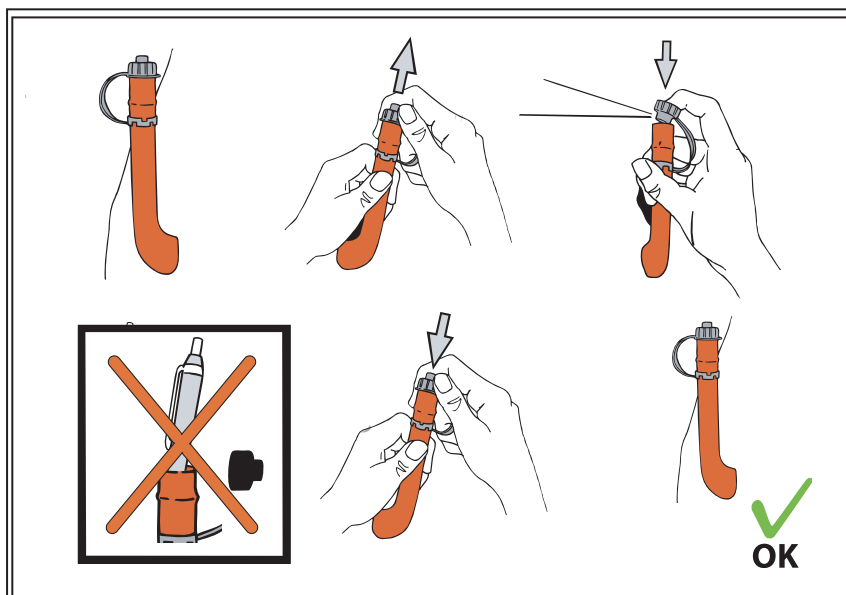

## Inspection 4:

Inspection of CO2 Cylinder. Check that correct type/size of CO2 cylinder is fitted to the inflation valve (printed on the bladder near inflation valve or the cylinder/inflation valve protective cover). Remove the CO2 cylinder by unscrewing it counter clockwise and inspect thoroughly. It should be intact with no rust or corrosion. Replace the cylinder if the end cap had been pierced, it is damaged or the cylinder exhibits signs of the rust or corrosion.

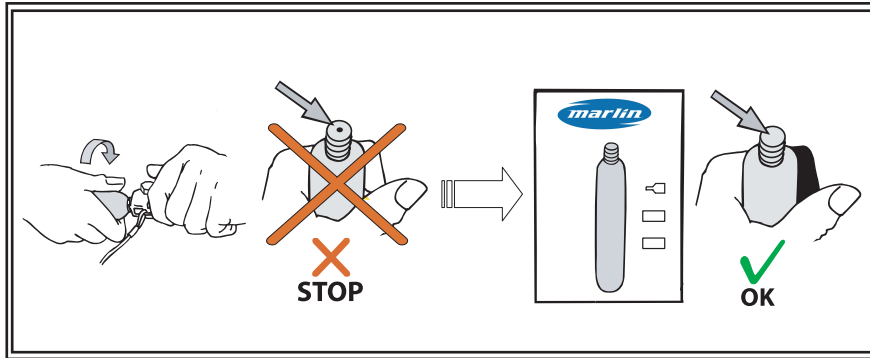

If the CO2 cylinder is serviceable check weigh of the cylinder on a kitchen or letter scales to ensure that the weight of the cylinder corresponds to the minimum gross weight engraved on the cylinder, (GR.WT)  $\pm 2$  g. If the weight is incorrect or the cylinder is in any way defective it must be replaced. (A replacement cylinder should also be checked in the same manner). Record engraved GR.WT. and actual weight of cylinder on your self inspection certificate.

NB! Make sure that all scraped CO2 cylinders are disposed of at once.

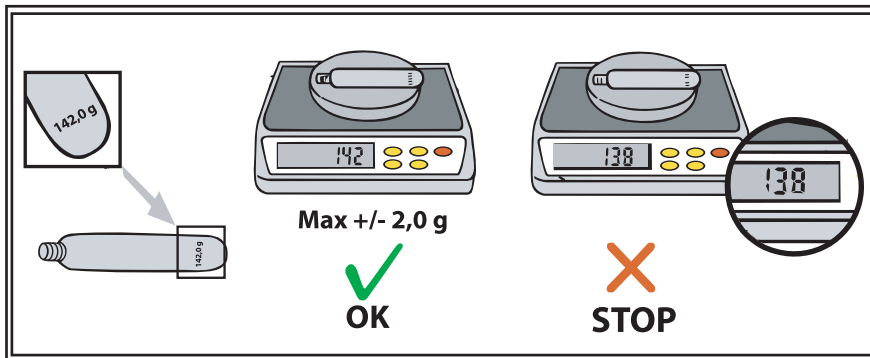

## Inspection 5:

With the CO2 cylinder removed, pull the manual lanyard sharply to ensure that the lever moves freely, and that the piercing cutter appears undamaged. If the lever moves freely and the piercing cutter appears undamaged, rearm the valve by folding back the lever into the normal position and secure with a new green firing indicator clip if your green clip is missing or damaged. If the valve does not operate properly, or if you are concerned about the operation of the mechanism, you must send the PFD to an accredited service agent for inspection and further action.

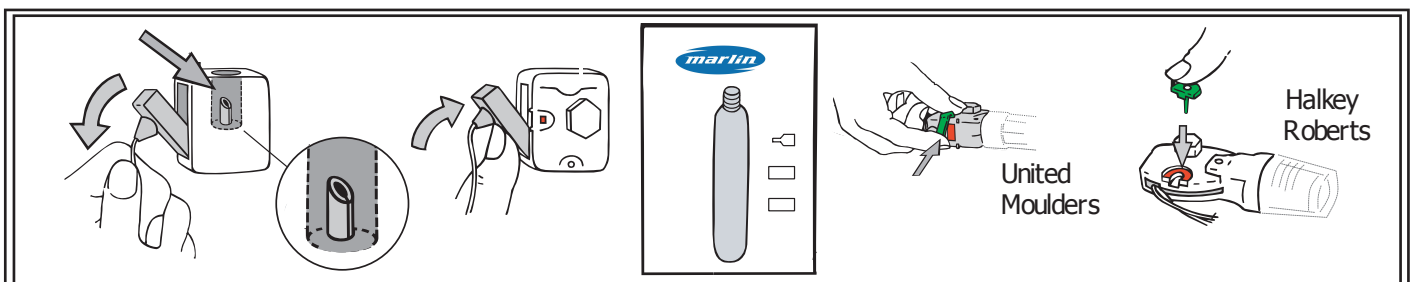

## Inspection 6:

Inspection and rearming of automatic inflation head (automatic models only) Cartridge or Bobbin (as applicable) must be replaced if it has been immersed in water, is past its expiry date or if the expiry date falls before PFD's next scheduled service.

- a. For automatic models fitted with United Molders automatic inflation head with water sensing cartridge (Fig 1) UML cartridge has 3 year lifespan and is printed with an expiry date.
1. Unscrew the cartridge turn counter clockwise.
  2. Check that the cartridge is clean and completely dry.
  3. Record the expiry date printed on the cartridge on the inspection certificate and check that the green indicator is in place. Discard and replace cartridge if expiry date falls within next 12 months or green indicator at base of cartridge is not visible.
  4. Rearm by screwing cartridge clockwise onto base of inflated head. Ensure thread is not obstructed and tighten firmly using light hand force only. Ensure that the green auto firing indicator (at base of cartridge) is present on any auto cartridge fitted to the inflator head.

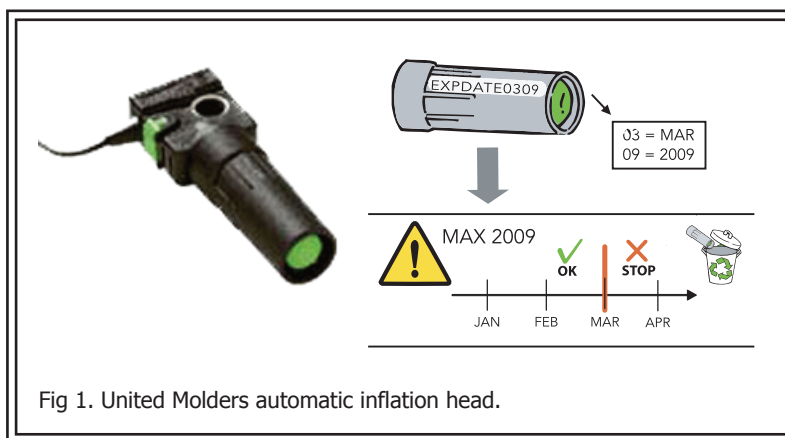

- b. For automatic models fitted with Halkey Roberts automatic inflation head with transparent cartridge and water sensing bobbin (Fig 2.). For Yellow Bobbin please note:

- Shelf life plus service life not to exceed 6 years
- Service life is 3 years from date bobbin is installed in inflator.
- Please check date on bobbin and replace if necessary.

### Procedure:

1. Check if green indicator is showing at the base of head. Remove the bobbin by unscrewing the transparent cartridge counter clockwise. Discard bobbin if has expired or green indicator at base of transparent head is not visible when armed. To rearm the Halkey Roberts automatic inflation head.
2. Fit the bobbin (the bobbin will only fit one way round).
3. Refit transparent cartridge by screwing it clockwise until hand tight.
4. Check that the green firing indicator is visible.

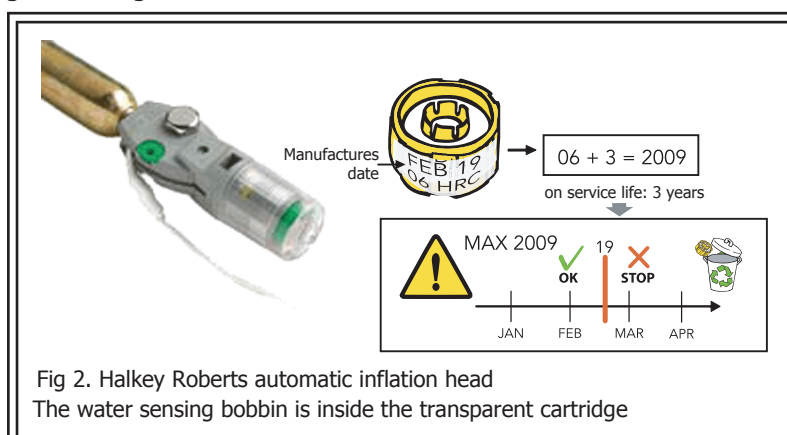

## Inspection 7:

Refitting the CO2 Cylinder

- Ensure that CO2 cylinder has passed inspection (Refer Instruction 4)
- Ensure that the inflation head has passed inspection and rearmed (Refer Instruction 5)
- Ensure that automatic cartridge has passed inspection and is rearmed. (Refer Instruction 6)
- Hold the unit firmly and screw the CO2 cylinder clockwise into top of the inflator head. Hand tighten until firm.

**DONOT USE ANY TOOL OR UNDUE FORCE**

**Warning:** When replacing with a new CO2 cylinder the new cylinder should be inspected as per Instruction 4. For the piercing cutter to work correctly both the CO2 cylinder and automatic cartridge (when fitted) must be firmly hand tightened onto inflation head.

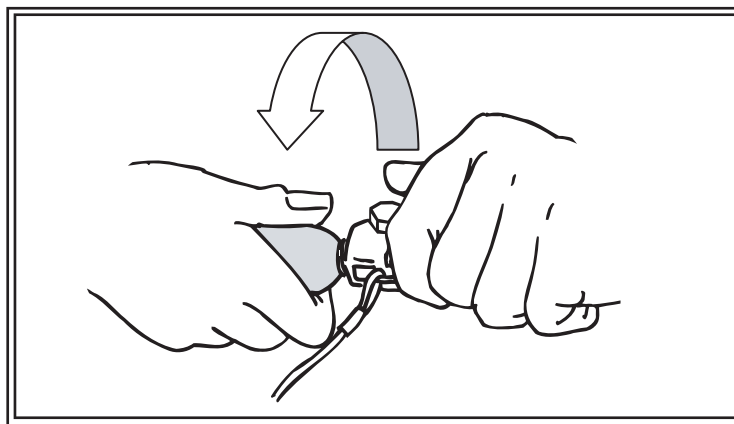

## Inspection 8:

Record service inspection on your PFD.

If the PFD has passed all applicable self inspection instructions described in Instructions 1 through 7, using permanent laundry marker Sign and date the Service Inspection label located on the inflation head side of the PFD bladder. Format for dating a self inspection should be SI-YY-MM (the prefix SI is to indicate self inspection) For example for a self inspection completed in August 2010 service schedule should show SI-10-08

## Inspection 9:

Repack PFD.

repack the PFD according to model instructions as described in your PFD owners manual. make sure the manual pull lanyard is not tangled and that the lanyard knob is hanging outside the PFD cover.

## Inspection 10:

Certify PFD inflatable Self Inspection Certificate

Sign self inspection certificate and record the date self inspection was completed. It is also recommended that the next inspection due date is noted in space provided and that the signed and dated certificate is placed in boat's safety equipment log for future reference.



## MARLIN INFLATABLE PFD ANNUAL SELF INSPECTION CERTIFICATE

### Applicable for inflatable PFD's in recreational use only

Before you start please read Marlin Annual Self Inspection and Service Instructions. Record each inspection instruction as described in the steps on the this certificate as it is completed. If the PFD or a component of the PFD fails any of the checks listed in Instructions 1-6 the PFD or the faulty component must be replaced before further use, alternatively the PFD should be sent to an accredited service agent for further inspection.

**Under no circumstances must you attempt any repairs yourself.**

Batch Number (mark clearly 8 numbers): .....

It is printed on the back of the inflatable PFD, at the bottom of the warning label Example: BATCH No. 1501-1234.

Model: .....

Last serviced date  
or date of purchase  
if no service

YY

MM

#### Check Status at each Instruction by marking box

Pass - YES

NA - Not Applicable

Fail - NO

#### Inspection 1

PASS

NO

NA

1.1 General visual inspection

1.2 Open outer cover and check

1.3 Harness component

#### Inspection 2

PASS

NO

NA

2.1 Check bladder for abrasion wear

2.2 Performed bladder leakage test

#### Inspection 3

PASS

NO

NA

3.1 Operation of mouth inflation tube and valve

#### Inspection 4

PASS

NO

NA

4.1 CO2 Cylinder for damage or corrosion

4.2 Check weighed cylinder

Record engraved GR.WT

Actual Weight

#### Inspection 5

PASS

NO

NA

5.1 Operation of inflation head and secured **new** firing

indicator clip If Its lost or damaged.

#### Inspection 6

PASS

NO

NA

6.1 Expiry date and green indicator is in place United Moulders

6.2 Expiry date and green indicator is in place Halkey Roberts

#### Inspection 7

7.1 Refit inspected or new CO2 Cylinder (Refer Instruction 4)

#### Inspection 8

8.1 Sign and date PFD service schedule attached to PFD

#### Inspection 9

9.1 Repack PFD (Refer: Owners Instructions manual supplied with PFD)

#### Inspection 10

I hereby certify that this PFD has been inspected and serviced in accordance with the Marlin Annual Self Inspection and Service Instructions describe in Instructions 1 through 9.

Next Inspection  
Due

.....  
Name

.....  
Signature

.....  
Date

.....  
Address



## MARLIN INFLATABLE PFD ANNUAL SELF INSPECTION CERTIFICATE

### Applicable for inflatable PFD's in recreational use only

Before you start please read Marlin Annual Self Inspection and Service Instructions. Record each inspection instruction as described in the steps on the this certificate as it is completed. If the PFD or a component of the PFD fails any of the checks listed in Instructions 1-6 the PFD or the faulty component must be replaced before further use, alternatively the PFD should be sent to an accredited service agent for further inspection.

**Under no circumstances must you attempt any repairs yourself.**

Batch Number (mark clearly 8 numbers): .....

It is printed on the back of the inflatable PFD, at the bottom of the warning label Example: BATCH No. 1501-1234.

Model: .....

Last serviced date  
or date of purchase  
if no service

YY

MM

#### Check Status at each Instruction by marking box

Pass - YES

NA - Not Applicable

Fail - NO

#### Inspection 1

PASS

NO

NA

1.1 General visual inspection

1.2 Open outer cover and check

1.3 Harness component

#### Inspection 2

PASS

NO

NA

2.1 Check bladder for abrasion wear

2.2 Performed bladder leakage test

#### Inspection 3

PASS

NO

NA

3.1 Operation of mouth inflation tube and valve

#### Inspection 4

PASS

NO

NA

4.1 CO2 Cylinder for damage or corrosion

4.2 Check weighed cylinder

Record engraved GR.WT

Actual Weight

#### Inspection 5

PASS

NO

NA

5.1 Operation of inflation head and secured **new** firing

indicator clip If Its lost or damaged.

#### Inspection 6

PASS

NO

NA

6.1 Expiry date and green indicator is in place United Moulders

6.2 Expiry date and green indicator is in place Halkey Roberts

#### Inspection 7

7.1 Refit inspected or new CO2 Cylinder (Refer Instruction 4)

#### Inspection 8

8.1 Sign and date PFD service schedule attached to PFD

#### Inspection 9

9.1 Repack PFD (Refer: Owners Instructions manual supplied with PFD)

#### Inspection 10

I hereby certify that this PFD has been inspected and serviced in accordance with the Marlin Annual Self Inspection and Service Instructions describe in Instructions 1 through 9.

Next Inspection  
Due

.....  
Name

.....  
Signature

.....  
Date

.....  
Address





## MARLIN INFLATABLE PFD ANNUAL SELF INSPECTION CERTIFICATE

### Applicable for inflatable PFD's in recreational use only

Before you start please read Marlin Annual Self Inspection and Service Instructions. Record each inspection instruction as described in the steps on the this certificate as it is completed. If the PFD or a component of the PFD fails any of the checks listed in Instructions 1-6 the PFD or the faulty component must be replaced before further use, alternatively the PFD should be sent to an accredited service agent for further inspection.

**Under no circumstances must you attempt any repairs yourself.**

Batch Number (mark clearly 8 numbers): .....

It is printed on the back of the inflatable PFD, at the bottom of the warning label Example: BATCH No. 1501-1234.

Model: .....

Last serviced date  
or date of purchase  
if no service

YY

MM

#### Check Status at each Instruction by marking box

Pass - YES

NA - Not Applicable

Fail - NO

#### Inspection 1

PASS

NO

NA

1.1 General visual inspection

1.2 Open outer cover and check

1.3 Harness component

#### Inspection 2

PASS

NO

NA

2.1 Check bladder for abrasion wear

2.2 Performed bladder leakage test

#### Inspection 3

PASS

NO

NA

3.1 Operation of mouth inflation tube and valve

#### Inspection 4

PASS

NO

NA

4.1 CO2 Cylinder for damage or corrosion

4.2 Check weighed cylinder

Record engraved GR.WT

Actual Weight

#### Inspection 5

PASS

NO

NA

5.1 Operation of inflation head and secured **new** firing

indicator clip If Its lost or damaged.

#### Inspection 6

PASS

NO

NA

6.1 Expiry date and green indicator is in place United Moulders

6.2 Expiry date and green indicator is in place Halkey Roberts

#### Inspection 7

7.1 Refit inspected or new CO2 Cylinder (Refer Instruction 4)

#### Inspection 8

8.1 Sign and date PFD service schedule attached to PFD

#### Inspection 9

9.1 Repack PFD (Refer: Owners Instructions manual supplied with PFD)

#### Inspection 10

I hereby certify that this PFD has been inspected and serviced in accordance with the Marlin Annual Self Inspection and Service Instructions describe in Instructions 1 through 9.

Next Inspection  
Due

.....  
Name

.....  
Signature

.....  
Date

.....  
Address



## MARLIN INFLATABLE PFD ANNUAL SELF INSPECTION CERTIFICATE

### Applicable for inflatable PFD's in recreational use only

Before you start please read Marlin Annual Self Inspection and Service Instructions. Record each inspection instruction as described in the steps on the this certificate as it is completed. If the PFD or a component of the PFD fails any of the checks listed in Instructions 1-6 the PFD or the faulty component must be replaced before further use, alternatively the PFD should be sent to an accredited service agent for further inspection.

**Under no circumstances must you attempt any repairs yourself.**

Batch Number (mark clearly 8 numbers): .....

It is printed on the back of the inflatable PFD, at the bottom of the warning label Example: BATCH No. 1501-1234.

Model: .....

Last serviced date  
or date of purchase  
if no service

YY

MM

#### Check Status at each Instruction by marking box

Pass - YES

NA - Not Applicable

Fail - NO

#### Inspection 1

PASS

NO

NA

1.1 General visual inspection

1.2 Open outer cover and check

1.3 Harness component

#### Inspection 2

PASS

NO

NA

2.1 Check bladder for abrasion wear

2.2 Performed bladder leakage test

#### Inspection 3

PASS

NO

NA

3.1 Operation of mouth inflation tube and valve

#### Inspection 4

PASS

NO

NA

4.1 CO2 Cylinder for damage or corrosion

4.2 Check weighed cylinder

Record engraved GR.WT

Actual Weight

#### Inspection 5

PASS

NO

NA

5.1 Operation of inflation head and secured **new** firing

indicator clip If Its lost or damaged.

#### Inspection 6

PASS

NO

NA

6.1 Expiry date and green indicator is in place United Moulders

6.2 Expiry date and green indicator is in place Halkey Roberts

#### Inspection 7

7.1 Refit inspected or new CO2 Cylinder (Refer Instruction 4)

#### Inspection 8

8.1 Sign and date PFD service schedule attached to PFD

#### Inspection 9

9.1 Repack PFD (Refer: Owners Instructions manual supplied with PFD)

#### Inspection 10

I hereby certify that this PFD has been inspected and serviced in accordance with the Marlin Annual Self Inspection and Service Instructions describe in Instructions 1 through 9.

Next Inspection  
Due

.....  
Name

.....  
Signature

.....  
Date

.....  
Address



## MARLIN INFLATABLE PFD ANNUAL SELF INSPECTION CERTIFICATE

### Applicable for inflatable PFD's in recreational use only

Before you start please read Marlin Annual Self Inspection and Service Instructions. Record each inspection instruction as described in the steps on the this certificate as it is completed. If the PFD or a component of the PFD fails any of the checks listed in Instructions 1-6 the PFD or the faulty component must be replaced before further use, alternatively the PFD should be sent to an accredited service agent for further inspection.

**Under no circumstances must you attempt any repairs yourself.**

Batch Number (mark clearly 8 numbers): .....

It is printed on the back of the inflatable PFD, at the bottom of the warning label Example: BATCH No. 1501-1234.

Model: .....

Last serviced date  
or date of purchase  
if no service

YY

MM

#### Check Status at each Instruction by marking box

Pass - YES

NA - Not Applicable

Fail - NO

#### Inspection 1

PASS

NO

NA

1.1 General visual inspection

1.2 Open outer cover and check

1.3 Harness component

#### Inspection 2

PASS

NO

NA

2.1 Check bladder for abrasion wear

2.2 Performed bladder leakage test

#### Inspection 3

PASS

NO

NA

3.1 Operation of mouth inflation tube and valve

#### Inspection 4

PASS

NO

NA

4.1 CO2 Cylinder for damage or corrosion

4.2 Check weighed cylinder

Record engraved GR.WT

Actual Weight

#### Inspection 5

PASS

NO

NA

5.1 Operation of inflation head and secured **new** firing

indicator clip If Its lost or damaged.

#### Inspection 6

PASS

NO

NA

6.1 Expiry date and green indicator is in place United Moulders

6.2 Expiry date and green indicator is in place Halkey Roberts

#### Inspection 7

7.1 Refit inspected or new CO2 Cylinder (Refer Instruction 4)

#### Inspection 8

8.1 Sign and date PFD service schedule attached to PFD

#### Inspection 9

9.1 Repack PFD (Refer: Owners Instructions manual supplied with PFD)

#### Inspection 10

I hereby certify that this PFD has been inspected and serviced in accordance with the Marlin Annual Self Inspection and Service Instructions describe in Instructions 1 through 9.

Next Inspection  
Due

.....  
Name

.....  
Signature

.....  
Date

.....  
Address